

# Wiper Mechanism Replacement

<b>Document Reference</b>	JTV-0002
<b>Date Created</b>	November 2016
<b>Referenced Vehicle</b>	Jaguar S Type "R" 4.2L 2003MY
<b>Referenced Vehicle VIN</b>	M6937x
<b>Supporting Video</b>	<a href="https://www.youtube.com/watch?v=xS3uKlcFoAA">https://www.youtube.com/watch?v=xS3uKlcFoAA</a>
<b>Author</b>	Brian of jagtv.co.uk
<b>Contact</b>	hello@jagtv.co.uk
<b>Disclaimer</b>	<p>Please note that material contained in this document and any supporting YouTube video is not endorsed by Jaguar Land Rover Ltd in any way.</p> <p>Whilst JagTV always tries to ensure that the information in its website, videos or associated documents is accurate and helpful, we cannot ultimately warrant the accuracy of that information and cannot be held liable for any use or reliance you may make of or put on it or any resultant loss or damage.</p>

## Introduction & Overview

This document and associated YouTube Video provides a hands-on (DIY) guide to replacing a Windscreen Wiper Mechanism on a Jaguar S Type R 4.2L 2003MY. The mechanism was replaced in this instance as the R/H (Driver's side UK) wiper arm was fouling the underside lip of the bonnet (hood). On close inspection, it was found that the wiper arm spindle had excessive lateral movement (and plenty of rust) which resulted in tipping the wiper arm during operation and striking the bonnet (hood).



## Part(s) Required / Recommended

Part Number	Description	Price
	<p>The entire mechanism, motor and linkage was replaced by a good condition used unit acquired through an Ebay seller.</p> <p>Be very selective when buying a used mechanism through Ebay as price is not necessarily an indication of condition.</p> <p>Alternatively use a reputable local Jaguar breaker and select the mechanism yourself.</p>	<p>Expect to pay between £45.00 and £100.00 for a used mechanism through Ebay.</p>
		
	Recommended UK Ebay Seller - ver500770	

## Tools / Equipment Required

- No special equipment is required
- Long series  $\frac{3}{8}$ " drive sockets and ratchet drive
- $\frac{3}{8}$ " drive extension "wobble bar" (for brake booster nuts inside car foot well)
- Windscreen wiper arm removal tool. (Ebay)
- 1pt/2pt Pozi Screwdrivers
- Wiper Arm Puller



# Step By Step Instructions

1.

Remove wiper arm and blade assemblies. To do this remove both wiper arms (noting position by marking the windscreen with tape). It will be necessary to use a special removal puller to do this.

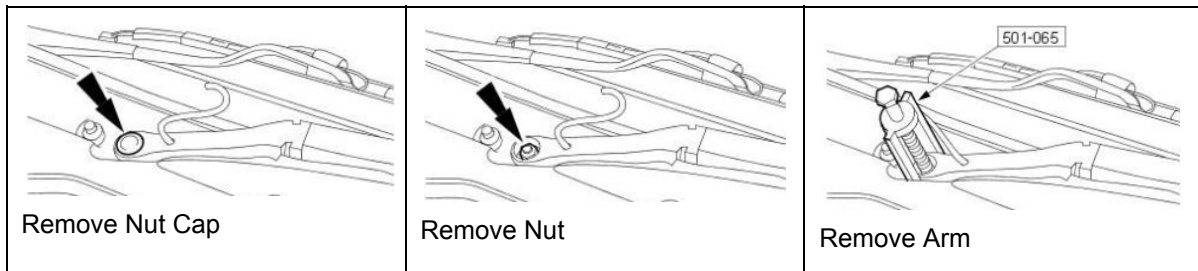

2.

Remove lower windscreen finisher - (also known as scuttle or cowling)

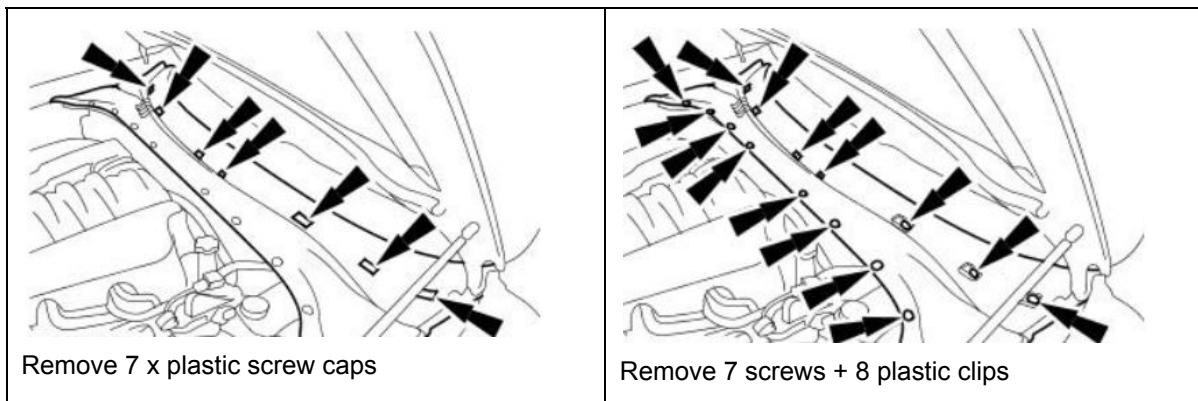

(The plastic retaining clips are removed by pushing down on the centre pin and lifting clip out.)

---

### 3.

Remove Engine Compartment Support.

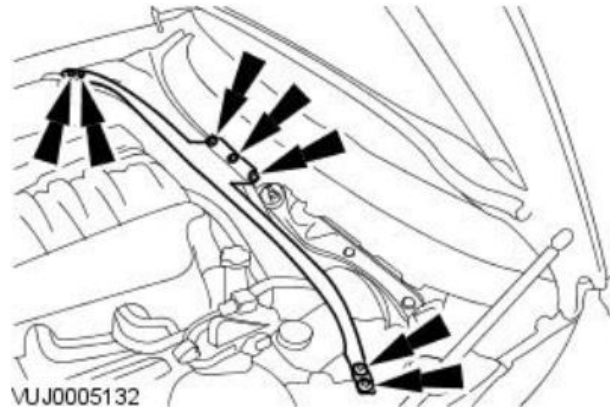

Remove 7 x 6mm bolts (10mm socket)

**CAUTION** - The two outer bolts on either side are usually corroded in and the heads can shear off. Use a 3/8" drive wrench and "ease" them out gradually.

The process we used to remove these corroded bolts: -

Before undoing - spray the bolts underneath the wing with rust easing fluid then tighten the bolt a little clockwise (this helps "break" the corrosion) - then turn a little anti-clockwise - then clockwise a little - then anti-clockwise a little at a time. The bolt/s with patience will undo and come out. Before refitting these bolts, wire brush the threads and coat in copper grease. On our car, we replaced the bolts with M8 x 25 Flanged Head A2 Stainless Steel bolts.

---

### 4.

Loosen the Brake Booster - (this allows the booster to be moved forward giving more clearance for the wiper assembly to be removed)

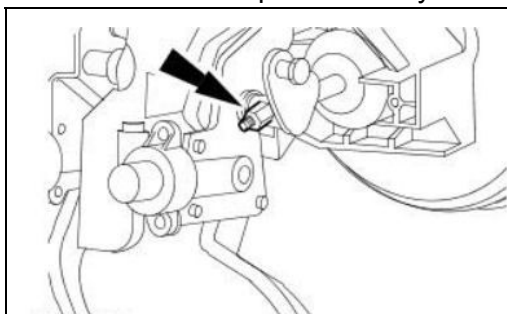

Loosen control rod nylon nut fully but do not remove completely.

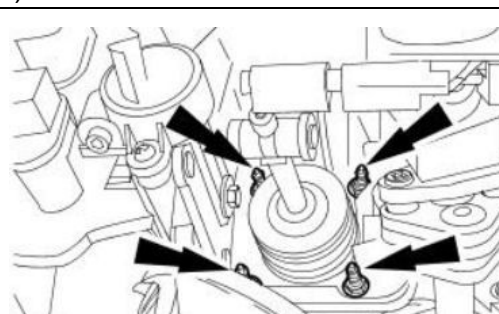

Loosen all four booster retaining bolt fully But do not remove completely.

---

5.



Move brake booster forward.



Release pipe clamp  
(allows booster to move)

6.

Remove Wiper Mechanism

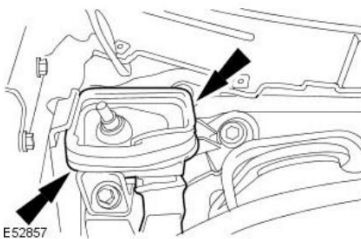

Remove drain hose

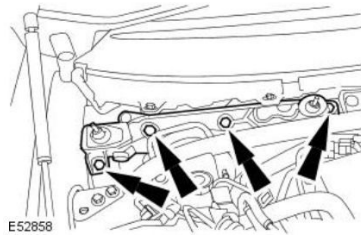

Remove 4 x mounting bolts

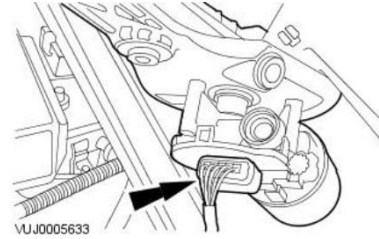

Disconnect electrical  
connector



---

7.

Remove wiper mechanism from vehicle



---

8.

Reverse above procedure for fitting the replacement wiper mechanism.

(Note – There is a location pin hole on the upper edge of the alloy casting)

## Additional Notes

Please note that the guidelines provided in this document and related video apply specifically to the Jaguar S Type R 4.2L 2003MY - VIN M6937x range.

Other models may be similar.

Always check that replacement parts are suitable/compatible before buying. Use your vehicle's VIN reference (Vehicle Identification Number) to correctly identify part suitability.

This can normally be found in your vehicle registration document or quite simply by viewing the number on top of your dashboard cowl through the front windscreen.